

St. Anthony Catholic School ~ Transportation Map

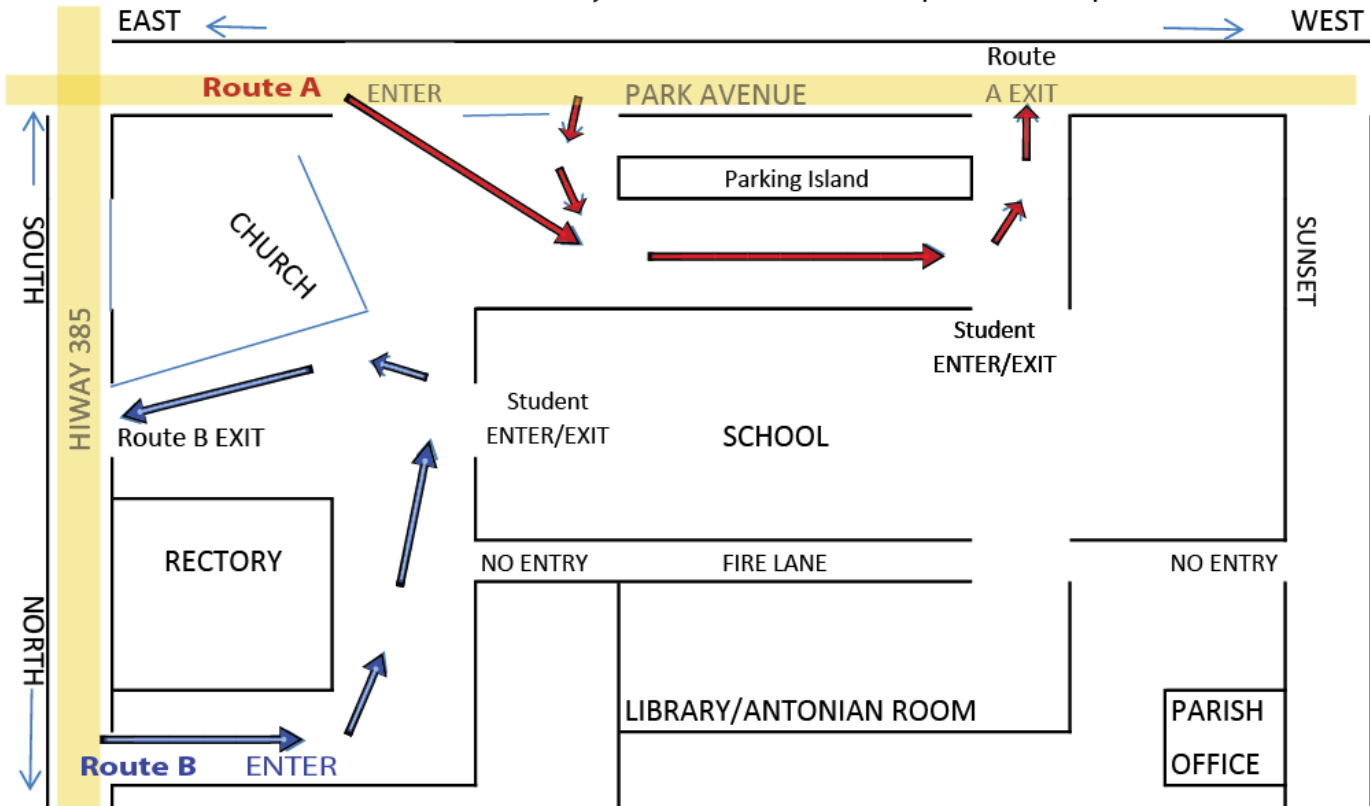

Transportation

In order to protect the safety of our children when dropping off and picking up students, please follow the following traffic control pattern on the map. Safety is our primary goal during student arrival and dismissal. Therefore, we must follow the designated routes. *Please drive slowly and use extreme caution.*

There are two routes for dropping off and picking up children. Pre-School children and their siblings will be dropped off at the east door in the mornings. Pre-School parents are expected to walk their children to their classroom. Pre-School will dismiss at 11:45 a.m. using the drive through **Route B**. All other families will use **Route A** in the morning. At the end of the day dismissal at 3:30 p.m., families with names ending in A-J will follow **Route A** at the south door. Families with names ending in K-Z will use **Route B** at the east door. The division of letters is subject to change. You will be advised of any changes in the weekly communication. **All families MUST follow the routes.** You will be given Family Name Signs to help the teachers and volunteers on door duty escort the children to the correct vehicle. **It is very dangerous for you to park and walk your children across the drop off lines; we ask that you please refrain from this practice. We also ask that you be deliberate and consistent in utilizing the Family Name Sign.** (Be aware that Park Avenue has a yellow striped area between the enter/exit drives. You can cross over this area but it is illegal to stop in this area to wait for oncoming traffic. Traffic exiting from **Route A** will move faster if you turn right instead of waiting to turn left across traffic. Please follow the arrows.) If you have business in the school before or after school, park at the east parking lot, closest to the church, and enter through the east doors. If you pull in close to the building, you may not be able to get out. It also blocks the view of other drivers if a child should dart out.

Parents are asked to pay close attention during the arrival and dismissal process. It is recommended that **cell phones not be used at this time.** Please follow the traffic directions given by the teachers on duty.